

**275**

**Technology  
Drive**

**CANONSBURG PA 15317**



**CBRE**

**M&JWILKOW**

# 275

# Technology Drive

## BUILDING INFORMATION

- Total Building Size:  
107,872 RSF
- Availability:  
Second Floor: 17,632 RSF  
fully customizable
- Parking: 4/1,000 RSF
- Drive-in door access
- Loading dock
- Full building generator
- Situated at the highest point  
in the park, with unmatched  
views and visibility from I-79



# Floor Plans

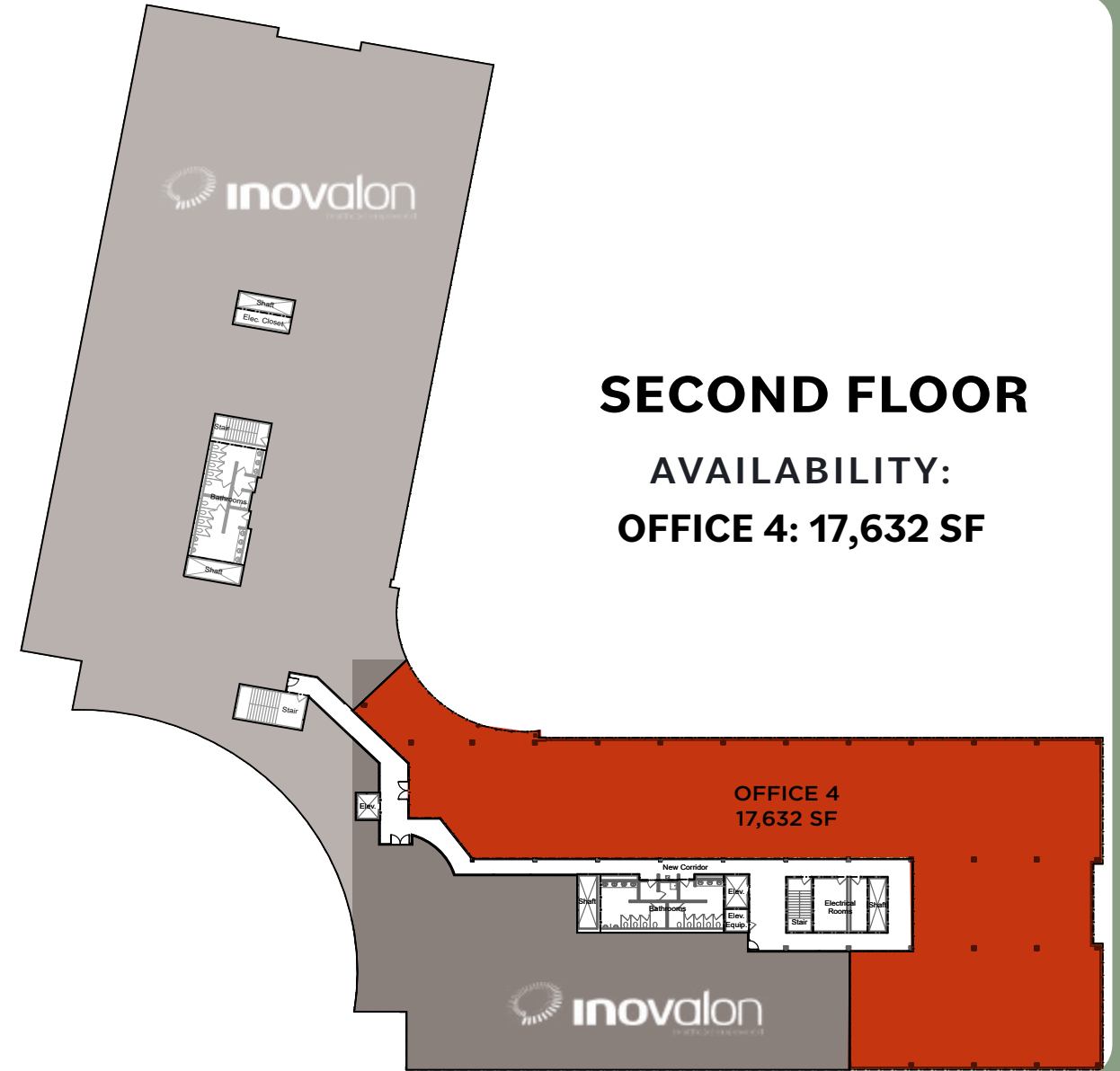

## SECOND FLOOR

AVAILABILITY:  
OFFICE 4: 17,632 SF

## LAST SPACE REMAINING

# BUILDING UPGRADES



**New roof**



**New building  
mechanicals**



**New building lobby  
and common areas**



**New Tenant  
fitness center**



**New outdoor  
amenity area with  
free wi-fi, soft seating  
and sport court**



**Upgraded parking field**



# 275

## Technology Drive

STAIRWELL



  
VIRTUAL TOUR:  
UPDATED LOBBY &  
COMMON AREA



  
VIRTUAL TOUR:  
UPDATED TENANT FITNESS CENTER





# 275

## Technology Drive

### CONTACT US:

**ADAM P. VICCARO, SIOR**

Senior Vice President  
412 471 3285  
adam.viccaro@cbre.com

**DOMINIKA DEMANTOVA**

Senior Associate  
412 471 4065  
dominika.demantova@cbre.com

**CARMINE DILUCENTE**

Senior Vice President  
412 427 4412  
carmine.dilucente@cbre.com

© 2026 CBRE, Inc. All rights reserved. This information has been obtained from sources believed reliable but has not been verified for accuracy or completeness. CBRE, Inc. makes no guarantee, representation or warranty and accepts no responsibility or liability as to the accuracy, completeness, or reliability of the information contained herein. You should conduct a careful, independent investigation of the property and verify all information. Any reliance on this information is solely at your own risk. CBRE and the CBRE logo are service marks of CBRE, Inc. All other marks displayed on this document are the property of their respective owners, and the use of such marks does not imply any affiliation with or endorsement of CBRE. Photos herein are the property of their respective owners. Use of these images without the express written consent of the owner is prohibited.